

STAB Balsa 40/10

BASE DE DERIVE ENTRE C6 ET C7 Balsa 20/10

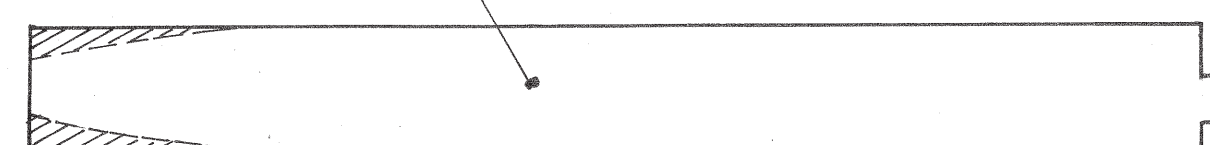

BASE DERIVE Balsa 20/10

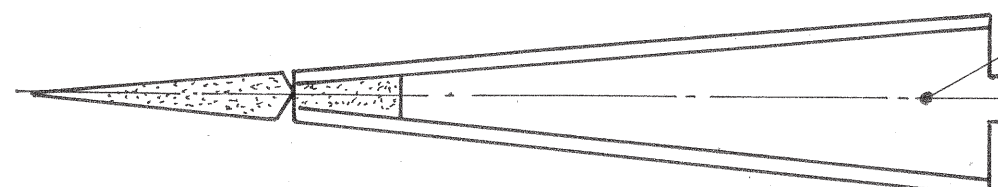

DERIVE SOUS STAB Balsa 20/10

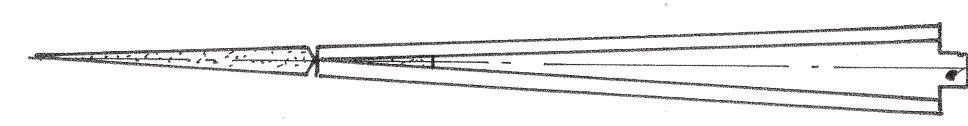

DERIVE SUR STAB Balsa 20/10



GRUMMAN COUGAR F9-F8
 Conception/Dessin : Laurent Berlivet (01/1992)
 Planche 1/2
 Envergure : 77 cm
 Longueur : 85 cm
 Profils : Evolution NACA 2412 à 2415
 Surface : 15 dm²
 Poids : 590 g
 Charge alaire : 40 g/dm²
 Moteur : Cox Tee Dee 0,8 cc (voire plus)
 Radio : 2 ou 3 voies

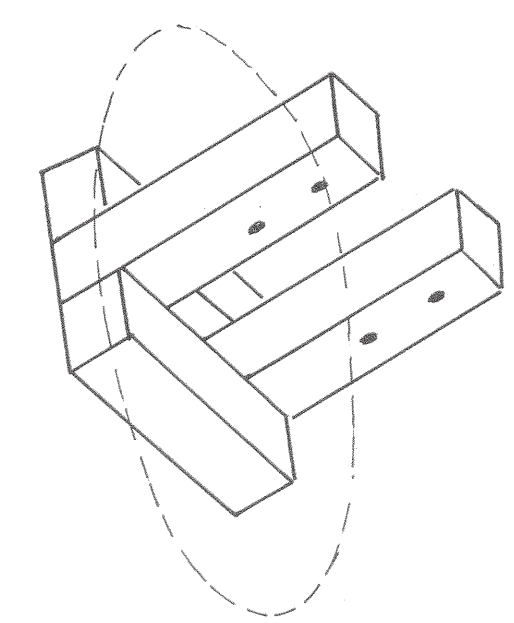

BATI MOTEUR

LE STAB EST PRIS ENTRE DEUX EPAISSEURS DE Balsa 40/10



Balsa 20/10 PROFILE

COFFRAGE Balsa 10/10

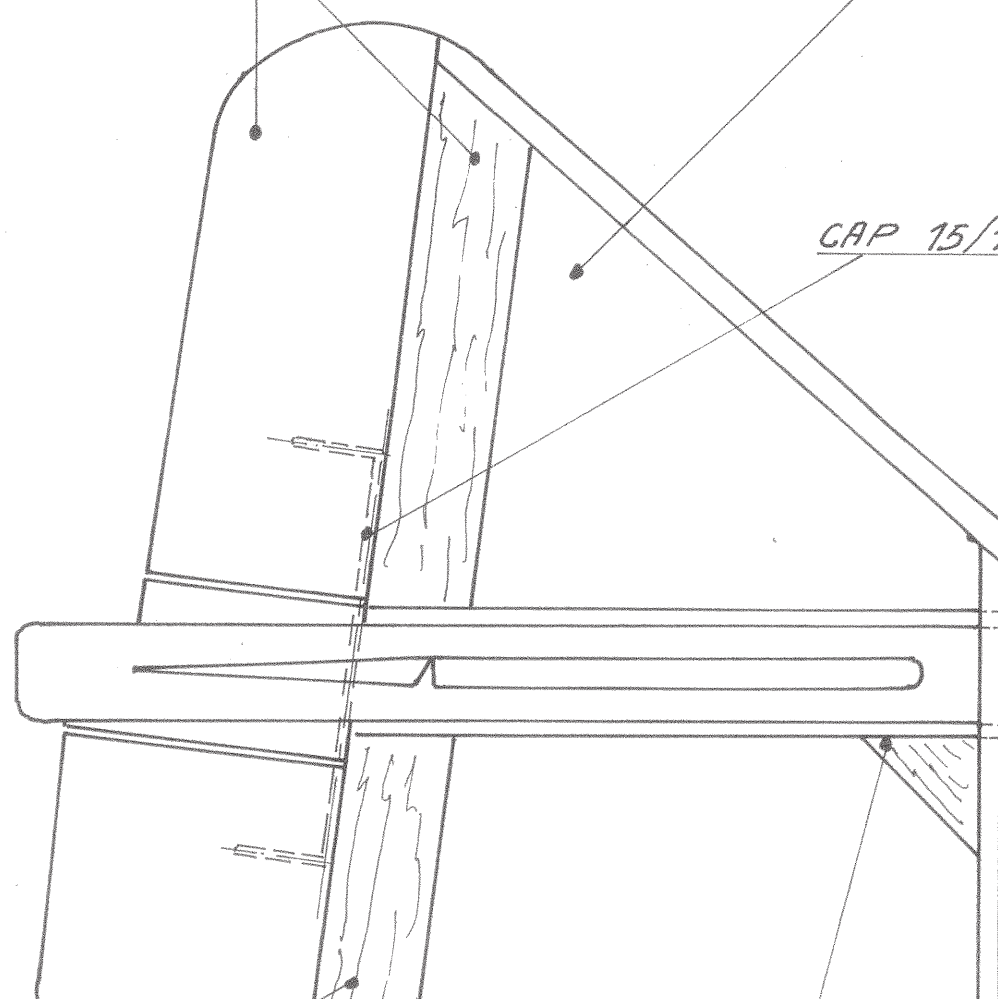

CAP 15/10

2 x 30/10 PROFILE

RENFORTS 30/10

COFFRAGE Balsa 20/10

BLOC Balsa

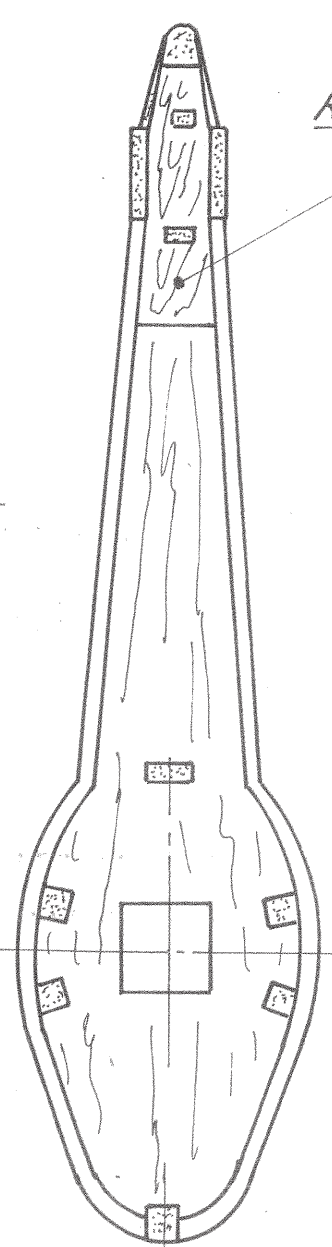

RENFORT C.T.P. 4/10

LES LONGERONS SONT EN Balsa 6x6

PARTIE A SUPPRIMER POUR LE PASSAGE DE L'AIL

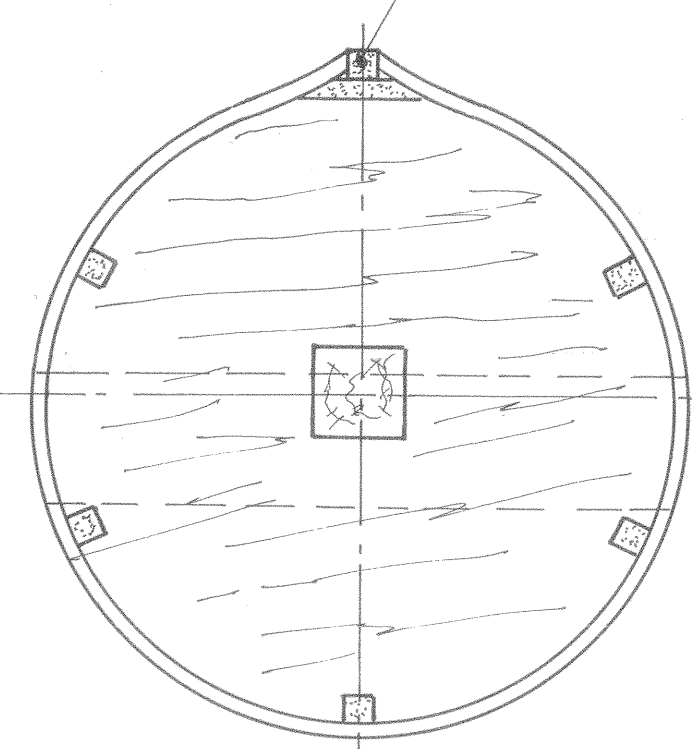

C7

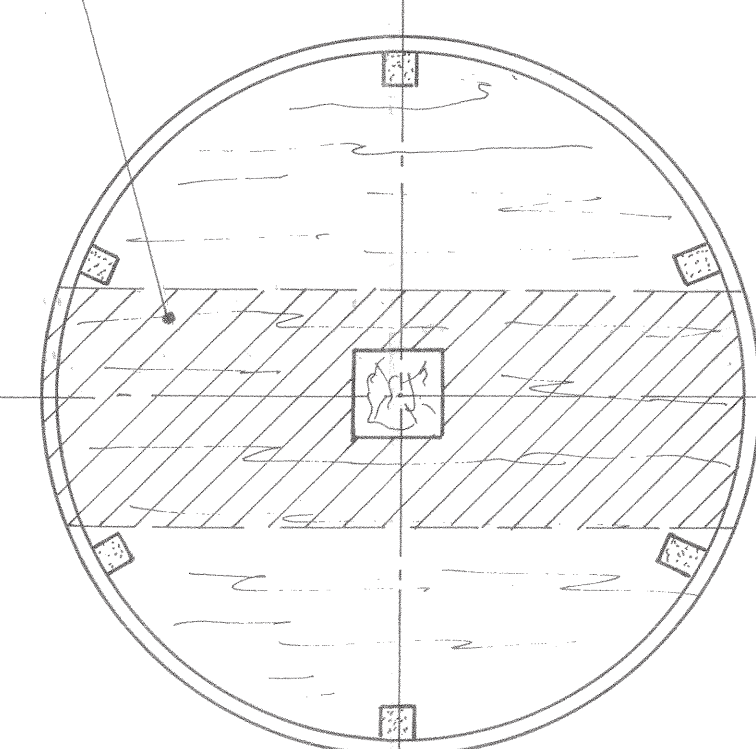

C6

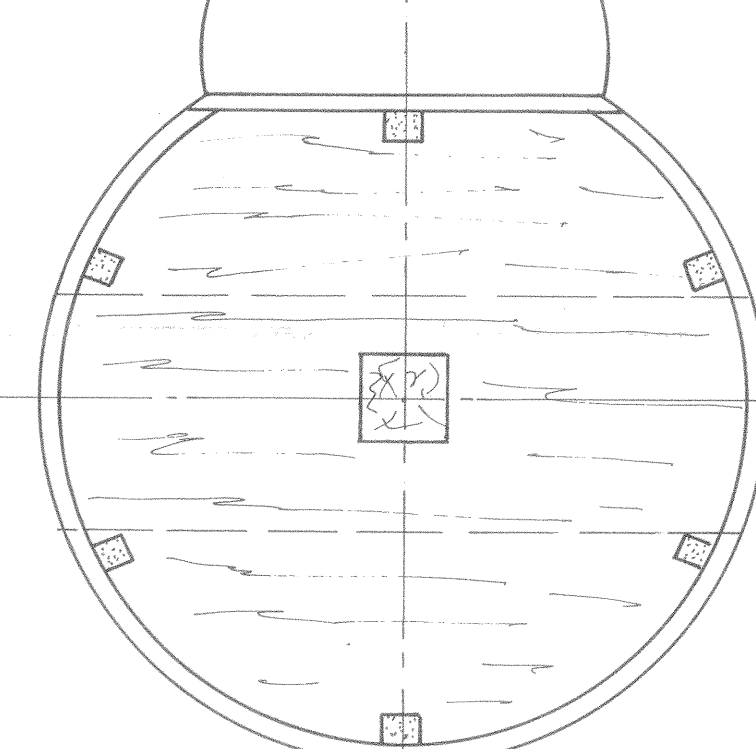

C5

VERRIERE THERMOFORMEE

TOUS LES COUPLES Balsa 30/10 SAUF C2 EN C.T.P. 30/10

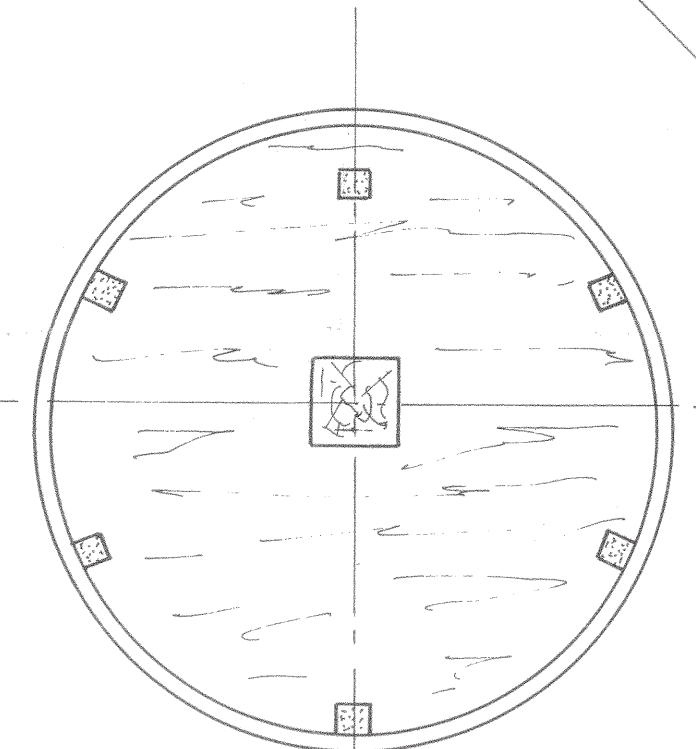

C4

SUPPORT MOTEUR BOIS DUR 10/10

PARTIE DU COFFRAGE A SUPPRIMER POUR MONTER LE MOTEUR

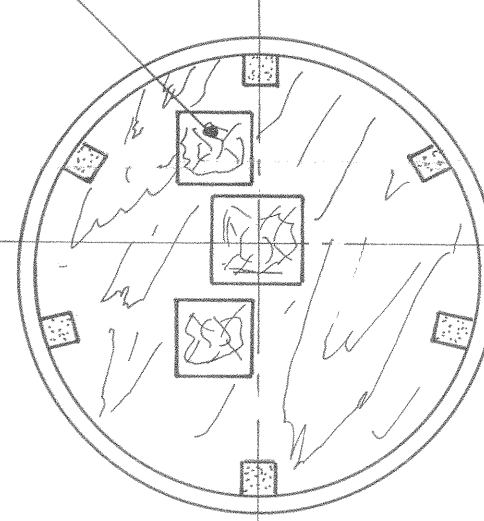

C3

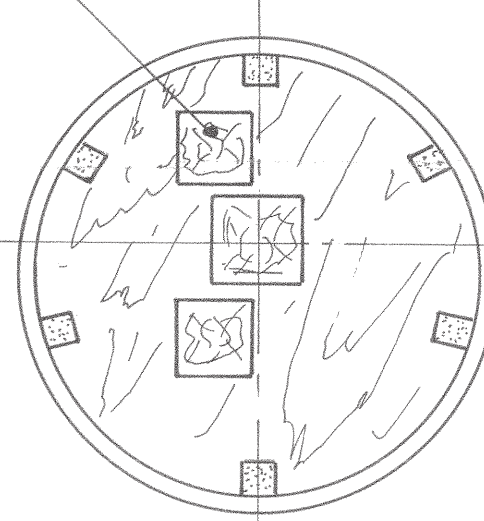

C2

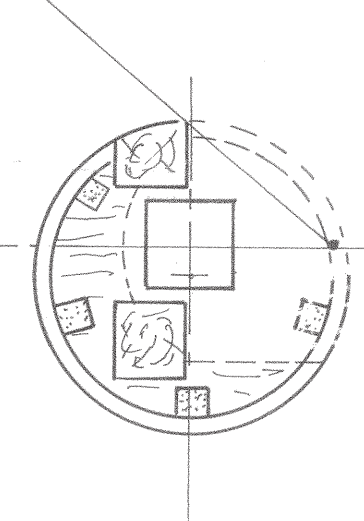

C1

TRAPPE DECOUPEE APRES MAROUFLAGE

BASE DERIVE

COFFRAGE Balsa 20/10

AXE FUSELAGE SAMBA 12x12

LE FUSELAGE EST INTEGRALEMENT COFFRE EN Balsa 20/10 SAUF LA PARTIE SUPERIEURE DE LA DERIVE EN Balsa 10/10

AIL CALEE A 1° 30'

COTE GAUCHE